

LB20
SKYTOUCH 20



CE V  IP20 t_a:40°C t_c:100°C

User Manual
KEEP THIS MANUAL FOR FUTURE NEEDS



ADD F1-5, Block 3, No.95, Guangzhu Rd, Lanhe Town, Nansha District,
Guangzhou 511480

Tel. +86 20 8499 2310/2320/2330

Fax +86 20 8499 2360

E-mail info@color-imagination.com

Website www.color-imagination.com

**Follow
us on**



www.facebook.com/colorimagination.1



www.youtube.com/user/colorimaginationj



https://twitter.com/Color_lighting

1 SAFETY INSTRUCTIONS



CAUTION

Be careful with your operations. With a dangerous voltage you can suffer a dangerous electric shock when touching wires!

This device has left the factory in perfect condition. In order to maintain this condition and to ensure a safe operation, it is absolutely necessary for the user to follow the safety instructions and warning notes written in this user manual.



IMPORTANT

Damages caused by the disregard of this user manual are not subject to warranty. The dealer will not accept liability for any resulting defects or problems.

If the device has been exposed to temperature changes due to environmental changes, do not switch it on immediately. The arising condensation could damage the device. Leave the device switched off until it has reached room temperature.

This device falls under protection-class I. Therefore it is essential that the device be earthed.

The electric connection must be carried out by a qualified person.

The device shall only be used with rated voltage and frequency.

Make sure that the available voltage is not higher than stated at the end of this manual.

Make sure the power cord is never crimped or damaged by sharp edges. If this would be the case, replacement of the cable must be done by an authorized dealer.

Always disconnect from the mains, when the device is not in use or before cleaning it. Only handle the power cord by the plug. Never pull out the plug by tugging the power cord.

During initial start-up some smoke or smell may arise. This is a normal process and does not necessarily mean that the device is defective, it should decrease gradually.

Please don't project the beam onto combustible substances.

Fixtures cannot be installed on combustible substances, keep more than 50cm distance with wall for smooth air flow, so there should be no shelter for fans and ventilation for heat radiation.

If the external flexible cable or cord of this luminaire is damaged, it shall be exclusively replaced by the manufacturer or his service agent or a similar qualified person in order to avoid a hazard.

8 MAINTENANCE AND CLEANING

The following points have to be considered during the inspection:

- 1) All screws for installing the devices or parts of the device have to be tightly connected and must not be corroded.
- 2) There must not be any deformations on the housing, color lenses, fixations and installation spots (ceiling, suspension, trussing).
- 3) Mechanically moved parts must not show any traces of wearing and must not rotate with unbalances.
- 4) The electric power supply cables must not show any damage, material fatigue or sediments.

Further instructions depending on the installation spot and usage have to be adhered to by a skilled installer and any safety problems have to be removed.



CAUTION

Disconnect from mains before starting maintenance operation.



In order to make the lights in good condition and extend the life time, we suggest a regular cleaning to the lights.

- 1) Clean the inside and outside lens each week to avoid the weakness of the lights due to accumulation of dust.
- 2) Clean the fan each week.
- 3) A detailed electric check by approved electrical engineer each three months, make sure that the circuit contacts are in good condition, prevent the poor contact of circuit from overheating.

We recommend a frequent cleaning of the device. Please use a moist, lint-free cloth. Never use alcohol or solvents.

There are no serviceable parts inside the device. Please refer to the instructions under "Installation instructions".

Should you need any spare parts, please order genuine parts from your local dealer.

2 UNPACKING

White Laser, NO FAN, 0.7° Angle, Front Neon Ring, 2 Prism Wheels, Continuous PAN/TILT

The NO-FAN designed SKYTOUCH 20 is an ultra compact and light weight stylish moving head beam light with a white LASER source in a reliable, sage and fully sealed module, integrated with a set of unique high resolution optical system.

The fixture features 0.7° beam angle which helps to provide ultra long throw solid beam effect that it is close to parallel beam. The SKYTOUCH 20 is designed with a range of effects: 19 static gobos, 17 dichroic colors, 6-Color Wheel, 2 prism wheels, frost, focus, etc. It provides 360° continuous fast and smooth PAN/TILT movement with variable speed which delivers even more vivid visual effect to the show. The fixture supports DMX, RDM (Remote Device Management).

The fixture's exterior housing is beautifully balanced basing on a modern design philosophy with supremely harmonious interior structure for remarkable control. The sculpted body of the SKYTOUCH 20 achieves more than just a striking look. The 2*1/4 turn fastening omega clamps, available for vertical and horizontal plug-in, make installations fast and easy.

It's fast and quiet operation LASER source moving head beam. It's a perfect option for indoor application like small concerts, conference hall, DJ shows, club&bar, etc.

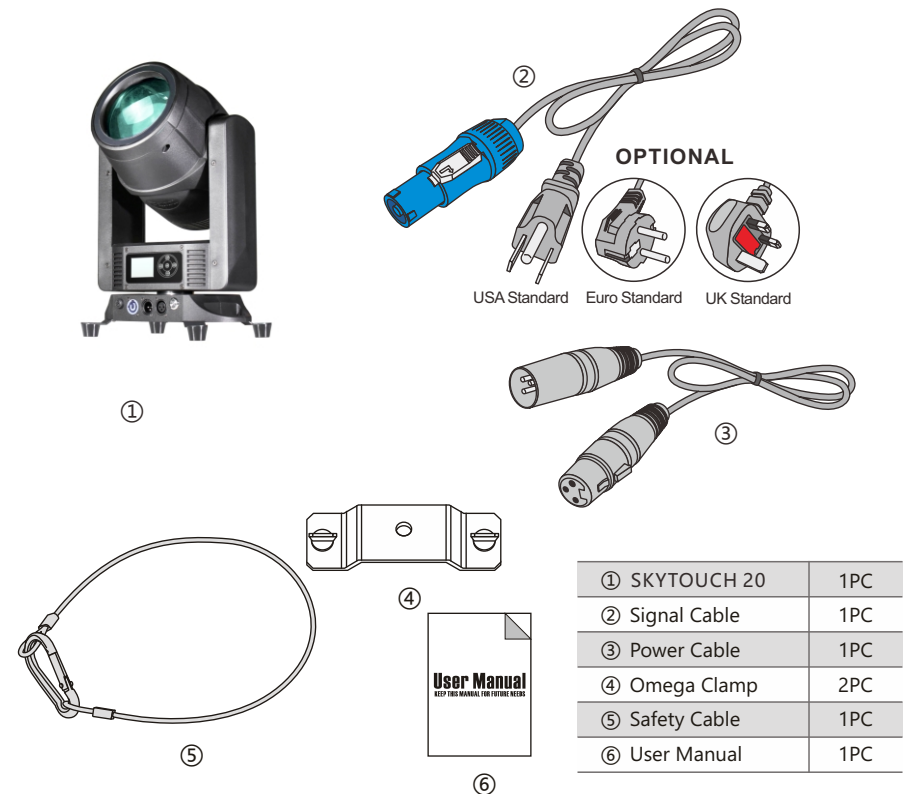

3 FEATURES & SPECIFICATIONS

1*White Laser

Color Temperature: 6000K

CRI: ≥70

Flicker free operation for broadcast TV and FILM

Life Span: 30000H

A set of high resolution and precise optics

0.7°Beam angle

Smooth and precise linear focus

PAN: 2 modes

1. 360°Continuous movement

2. 540°(8/16 bit)

TILT: 2 modes

1. 360°Continuous movement

2. 270°(8/16 bit)

Fast, quiet, smooth and precise 2-Phase motors

Smooth, fast and precise resolution for PAN/TILT movement with low noise operation

Scan position memory, auto reposition after unexpected movement

PAN/TILT reversible

1 Color wheel with 17 dichroic colors plus open

Variable direction rainbow effect with speed adjustable

6-Color wheel with variable direction and speed control

1 Neon ring effect with different built-in macro effects (variable speed control)

1 Static gobo wheel with 19 gobos plus open

2 Prism wheel design

Prism 1: 8-Facet circular prism with variable speed and direction

Prism 2: 3 different prisms, 6-Facet linear prism/16-facet circular prism/8+16-facet circular prism with

variable speed and direction

Prism indexing

Prism overlay (prism morphing)

0-25Hz shutter/strobe effect with variable speed

Preset variable/random strobe and dimming pulse effect

Even and soft coverage

0-100% Smooth linear dimming

25/28 DMX channels USITT DMX-512

DMX512, master-slave, or auto operation

DMX recorder and edit function integrated

RDM available (Remote Device Management)

Art-NET (Optional)

Wireless receiver system built-in (Optional)

Shielded input signal protection for stable signal without interference

RJ45 etherCON IN/OUT (Optional with Art-Net)

3-Pin and 5-pin XLR DMX connectors IN/OUT

Electronic supply with active PFC

AC100-240V 50/60Hz

PowerCON IN/ OUT with fuse

90W Power consumption

-25 to 45 ambient temperature

IP20 protection rating

N.W.: 9.7kg

G.W.: 12.2kg

Product Dimensions: 207(D)*268(W)*423.7(H)mm

Packing Dimensions: 310(D)*400(W)*530(H)mm

28CH	Function	DmxValue	Description
1	Pan	0 - 255	Horizontal rotation
2	PanFine	0 - 255	Horizontal fine-tuning
3	Tilt	0 - 255	Vertical rotation
4	TiltFine	0 - 255	Vertical fine-tuning
5	PTSpeed	0 - 255	Motor speed
6	Pan Rotate	0 - 255	Horizontal infinite rotation
7	TiltRotate	0 - 255	Vertical infinite rotation
8	Dim	0 - 255	Dimming
9	DimFine	0 - 255	Dimming and fine-tuning
10	Strobe	0 - 3	Shut
		4 - 103	Regular strobe, speed from slow to fast
		104 - 107	Open
		108 - 207	Pulse strobe, the speed changes from slow to fast
		208 - 212	Open
		213 - 225	Random slow strobe
		226 - 238	Random medium-speed strobe
		239 - 251	Random fast strobe
		252 - 255	Open
		11	Color
128 - 190	Manual rotation		
191 - 192	Rotate clockwise, and the speed changes from fast to slow.		
193 - 255	Stop		
193 - 255	It rotates counterclockwise, and the speed changes from slow to fast		
12	ColorFine	0 - 255	Color disk fine-tuning
13	Gobo	0 - 127	Solid map
		128 - 190	Manual rotation
		191 - 192	Rotate clockwise, and the speed changes from fast to slow.
		193 - 255	Stop
		193 - 255	It rotates counterclockwise, and the speed changes from slow to fast.
14	Prism1	0 - 127	Prism 1
		128 - 255	Shut
		128 - 255	Open
15	Prism1Rot	0 - 127	Prism 1 rotation
		128 - 190	Manual rotation
		191 - 192	Rotate clockwise, and the speed changes from fast to slow.
		193 - 255	Stop
16	Prism2	0 - 63	Prism 2
		64 - 127	Shut
		128 - 191	Eight prism
		192 - 255	Sixteen prism
		192 - 255	Rearranger
17	Prism2Rot	0 - 127	Prism 2 rotation
		128 - 190	Manual rotation
		191 - 192	Rotate clockwise, and the speed changes from fast to slow.
		193 - 255	Stop
18	Fog	0 - 99	Colorful atomization
		100 - 199	Shut
		200 - 255	Colorful
		200 - 255	Atomize
		200 - 255	Atomize
19	Focus	0 - 255	Focusing
20	FocusFine	0 - 255	Focus and fine-tuning
21	Reset	0 - 25	Reduce
		26 - 255	No effect
22	LedStripDim	0 - 255	Resumping execution (stay for 5 seconds)
23	LedStripStrobe	0 - 255	Light strip dimming
24	LedStripRed	0 - 255	Light band strobe
25	LedStripGreen	0 - 255	The light is red.
26	LedStripBlue	0 - 255	The light strip is green.
27	LedStripEffect	0 - 255	The light is blue.
28	LedStripEffectSpeed	0 - 255	Light strip effect
			Light strip effect speed

7 DMX CHANNELS

25CH	Function	DmxValue	Description
1	Pan	0 - 255	Horizontal rotation
2	PanFine	0 - 255	Horizontal fine-tuning
3	Tilt	0 - 255	Vertical rotation
4	TiltFine	0 - 255	Vertical fine-tuning
5	PTSpeed	0 - 255	Motor speed
6	Pan Rotate	0 - 255	Horizontal infinite rotation
7	Tilt Rotate	0 - 255	Vertical infinite rotation
8	Dim	0 - 255	Dimming
9	Strobe	0 - 3	Shut
		4 - 103	Regular strobe, speed from slow to fast
		104 - 107	Open
		108 - 207	Pulse strobe, the speed changes from slow to fast
		208 - 212	Open
		213 - 225	Random slow strobe
		226 - 238	Random medium-speed strobe
		239 - 251	Random fast strobe
		252 - 255	Open
10	Color	0 - 127	Color palette
		128 - 190	Manual rotation
		191 - 192	Stop
		193 - 255	It rotates counterclockwise, and the speed changes from slow to fast.
			Solid map
11	Gobo	0 - 127	Manual rotation
		128 - 190	Rotate clockwise, and the speed changes from fast to slow.
		191 - 192	Stop
		193 - 255	It rotates counterclockwise, and the speed changes from slow to fast.
12	Prism1	0 - 127	Prism 1
		128 - 255	Prism 1 rotation
			Prism 2 rotation
13	Prism1Rot	0 - 127	Manual rotation
		128 - 190	Rotate clockwise, and the speed changes from fast to slow.
		191 - 192	Stop
		193 - 255	It rotates counterclockwise, and the speed changes from slow to fast.
14	Prism2	0 - 63	Shut
		64 - 127	Eight prism
		128 - 191	Sixteen prism
		192 - 255	Rearranger
			Prism 2 rotation
15	Prism2Rot	0 - 127	Manual rotation
		128 - 190	Rotate clockwise, and the speed changes from fast to slow.
		191 - 192	Stop
		193 - 255	It rotates counterclockwise, and the speed changes from slow to fast.
16	Fog	0 - 99	Colorful atomization
		100 - 199	Shut
		200 - 255	Colorful
17	Focus	0 - 255	Atomize
			Focusing
18	Reset	0 - 25	Reduce
		26 - 255	No effect
			Resumping execution (stay for 5 seconds)
19	LedStripDim	0 - 255	Light strip dimming
20	LedStripStrobe	0 - 255	Light band strobe
21	LedStripRed	0 - 255	The light is red.
22	LedStripGreen	0 - 255	The light strip is green.
23	LedStripBlue	0 - 255	The light is blue.
24	LedStripEffect	0 - 255	The light is blue.
25	LedStripEffectSpeed	0 - 255	Light strip effect speed

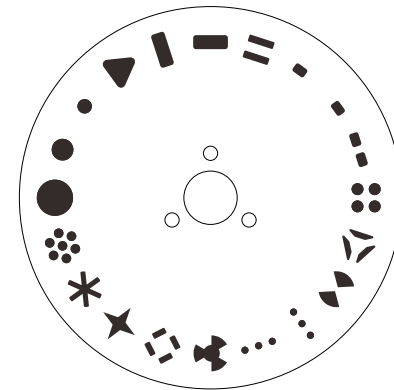
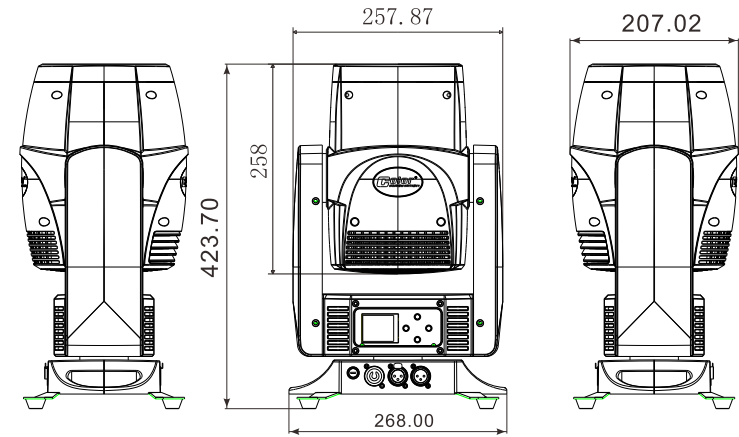

Static Gobo

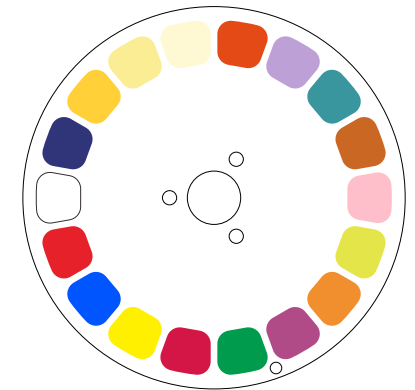

Colors

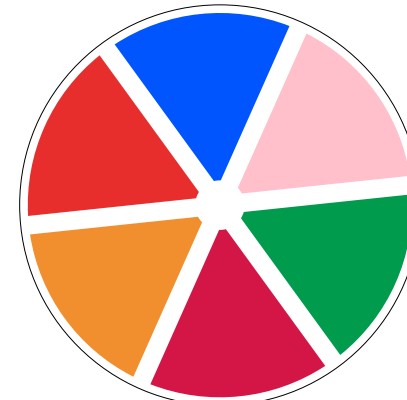

Color Wheel

Color

5 DMX-512 CONTROL CONNECTIONS

Connect the provided XLR cable to the female 3-pin XLR output of your controller and the other side to the male 3-pin XLR input of the architectural.

Architectural together through serial linking. The cable needed should be two core, screened cable with XLR input and output connectors. Please refer to the diagram below.

DMX-512 connection with DMX terminator.

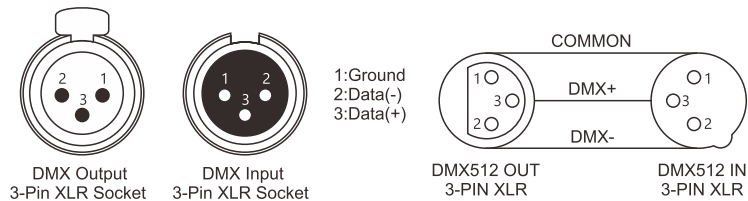

For installations where the DMX cable has to run a long distance or is in an electrically noisy environment, such as in a discotheque, it is recommended to use a DMX terminator. This helps in preventing corruption of the digital control signal by electrical noise. The DMX terminator is simply an XLR plug with a 120 Ω resistor connected between pins 2 and 3, which is then plugged into the output XLR socket of the last fixture in the chain. Please see illustrations below.

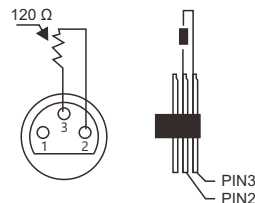

6 MENU OPERATIONS

Main Menu	Second	Third	Fourth
Dmx Address	000 - 512		
Fixture	DmxMode	STD/ EXT	
	Run Mode	DMX/ Host/ Sound	
	Pan Invert	Close/ Open	
	TiltInvert	Close/ Open	
	No DmxSignal	Clear/ Hold	
	SoundControl	1 -- 99	
Manual	Pan	000 - 255	
	Pan Fine	000 - 255	
	Tilt	000 - 255	
	TiltFine	000 - 255	
	?	?	
Information	Time	CurrentTime	xxxH
		TotalTime	xxxH
	Sensor	AllSensorare ok!	
		Temperature	HeadTemp
	SoftwareVersion	Panel	Vx.xx
		Motor	Vx.xx
Factory	Password	000 - 255	
	Pan	000 - 255	
	Tilt	000 - 255	
	Color	000 - 255	
	Gobo	000 - 255	
	Prism1	000 - 255	
	Prism1Rot	000 - 255	
	Prism2	000 - 255	
	Prism2Rot	000 - 255	
	Fog	000 - 255	
	Focus	000 - 255	
Fixture Reset	MotorReset	Cancel/ Run	
	Factory	Cancel/ Run	
Display	Language	CH/ EN	
	DisplayFlip	Normal/ Reverse	
	DisplayMode	60s/ Show	